

## Installation Instructions

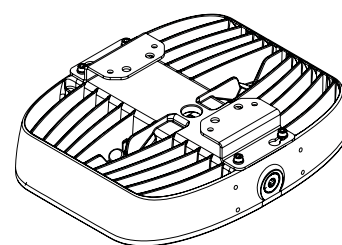
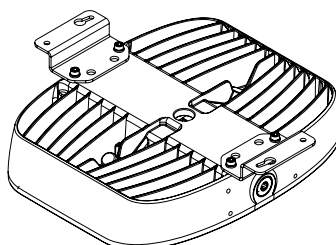
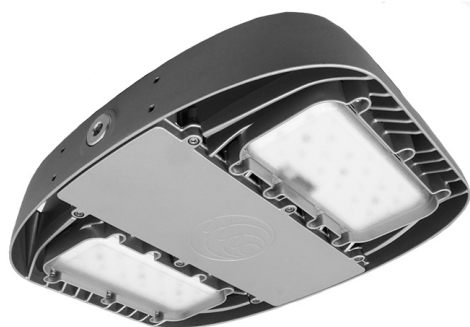

## Application

MR3 & MR6 Bay Luminaires are suitable for use in the following areas as defined by the National Electrical Code (NEC) and the Canadian Electrical Code (CEC):

Certified to: UL 844, UL 1598, UL 1598A and UL 8750  
CSA C22.2 No. 137, CSA C22.2 No. 250.0 and CSA C22.2 No. 250.13;

Hazardous Location Zone Approvals: Class I, Division 2, Groups ABCD, T4;  
Class II, Division 2, Groups FG, T4A;  
Class III;  
Class I, Zone 2, Group IIC;  
Zone 22

MR3 & MR6 Bay luminaires are designed for use indoors, outdoors, wet locations, and areas containing moisture, dirt, corrosion, vibration, and rough usage. The MR Bay luminaire is also certified for use as a marine, outside type (saltwater) non-recessed luminaire.

Housing: Copper-free Cast Aluminium with Polycarbonate lens

Voltage: AC: 120-277 VAC | HV: 347: 347 VAC 50/60Hz

Rated Current: MR3: 0.25A@120 VAC | 0.10A@347 VAC  
MR6: 0.50A@120 VAC | 0.20A@347 VAC

Connections: 3/4" NPT Conduit | Black: Line | White: Neutral/Line 2 | Green: Ground  
All field wiring supply conductors shall be rated 90°C minimum and rated for supply voltage (300V AC Models, 600V HV models). Class 1 Wiring Only.

Temperature Range: -40° C to +55° C

Ingress Protection: IP66 and IP67 rated for surface/suspension mount, yoke mount, pendant hook, and conduit connected installations only. | Suitable For Wet Locations. Marine Outside Type (Salt water).

## Warning

TO AVOID THE RISK OF FIRE, EXPLOSION, OR ELECTRIC SHOCK, THIS PRODUCT SHOULD BE INSTALLED, INSPECTED, AND MAINTAINED BY A QUALIFIED ELECTRICIAN ONLY, IN ACCORDANCE WITH ALL APPLICABLE ELECTRICAL CODES.

CE PRODUIT DOIT ÊTRE INSTALLÉ CONFORMÉMENT AU CODE D'INSTALLATION APPLICABLE PAR UNE PERSONNE FAMILIAIRE AVEC LA CONSTRUCTION ET LE FONCTIONNEMENT DU PRODUIT ET LES DANGERS IMPLIQUÉS

## Warning

POTENTIAL ELECTROSTATIC  
CHARGING HAZARD

ÉLECTROSTATIQUE POTENTIEL  
RISQUE DE CHARGE

## Warning

TO REDUCE THE RISK OF IGNITION OF HAZARDOUS ATMOSPHERES AND TO AVOID ELECTRIC SHOCK, DISCONNECT THE LUMINAIRE FROM THE SUPPLY CIRCUIT BEFORE OPENING FOR INSTALLATION AND SERVICING. KEEP TIGHTLY CLOSED WHEN IN OPERATION.

RISQUE POTENTIEL DE CHARGE ÉLECTROSTATIQUE - VOIR LES INSTRUCTIONS. POUR RÉDUIRE LE RISQUE DE COMBUSTION D'ATMOSPHÈRES DANGEREUSES, DÉBRANCHEZ LE LUMINAIRE DU CIRCUIT D'ALIMENTATION AVANT L'OUVERTURE. GARDER BIEN FERMÉ LORS DE L'UTILISATION.

AVOID ELECTROSTATIC DISCHARGE:

- CLEAN EXTERIOR LENS SURFACE WITH DAMP CLOTH ONLY  
ÉVITEZ LES DÉCHARGES ÉLECTROSTATIQUES:
- NETTOYEZ LA SURFACE EXTÉRIEURE DE LA LENTILLE UNIQUEMENT AVEC UN CHIFFON HUMIDE

## Installation Instructions

(Brackets are ordered separately)

Refer to alternate instructions if using Wall, Pole, Yoke, Conduit or Hook Mount

### MR-SM - Surface Mount Installation

#### Step 1.

Inspect shipping package and contents to ensure no damage has occurred during shipping.

#### Step 2.

Install included Surface/Suspension Mount Brackets.  
See diagram for orientation of brackets for each version.

Install with included M6 bolts and washers to 7 N-m  
(62 in-lbs).

#### Step 3.

- For surface mounting configuration, mount fixture to desired locations with 4x 1/4-20 OR M6 Screws or Bolts.

- For suspension mounting configuration,  
connect 4x anchors to points shown

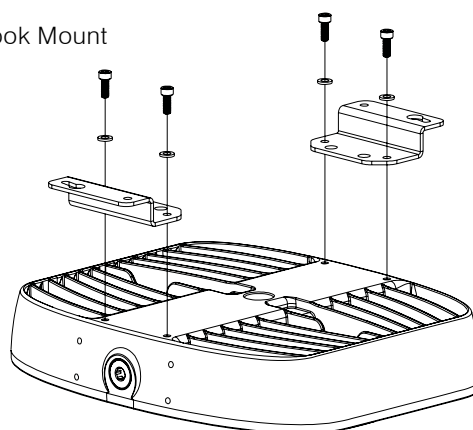

SURFACE MOUNTING CONFIGURATION

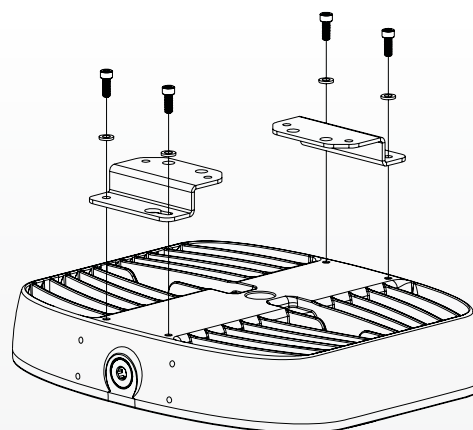

SUSPENSION MOUNTING CONFIGURATION

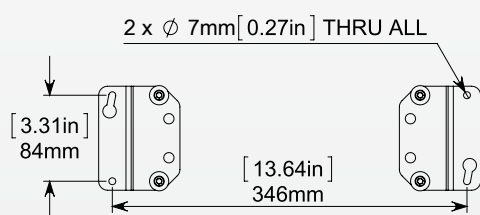

SURFACE MOUNTING CONFIGURATION

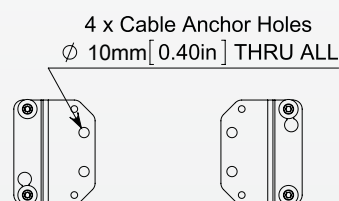

SUSPENSION MOUNTING CONFIGURATION

## Step 4.

To begin wiring, remove power supply lid by loosening six (6) M4 captive screws using a 3mm hex driver.

Allow the captive fasteners to remain in the lid for ease of re-installation.

The lid is secured with a retention cable.

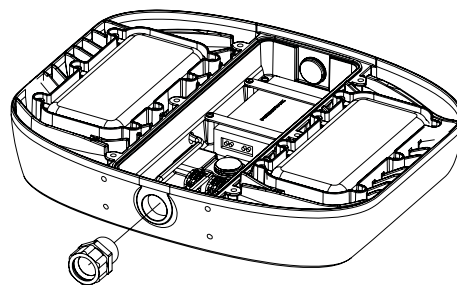

## Step 5.

Supply connection to be made through one of 3 3/4-14 NPT entries on the luminaire. If using Surface, Suspension or Yoke configuration, install appropriate Listed 3/4" NPT cable gland for cable size and be sure to follow all applicable local electrical codes for the specific hazardous locations. Torque cable gland base to manufacturer's recommended specification. All unused entries must be plugged with a NPT plug (two provided).

OR

Install Direct Rigid Conduit as per local electrical code. For direct rigid conduit installation, torque hand tight plus 2 to 3 turns

NOTE:

To aid in assembly and protection against ingress use of a petrolatum or soap thickened mineral oil based thread lubricant/sealant is necessary.

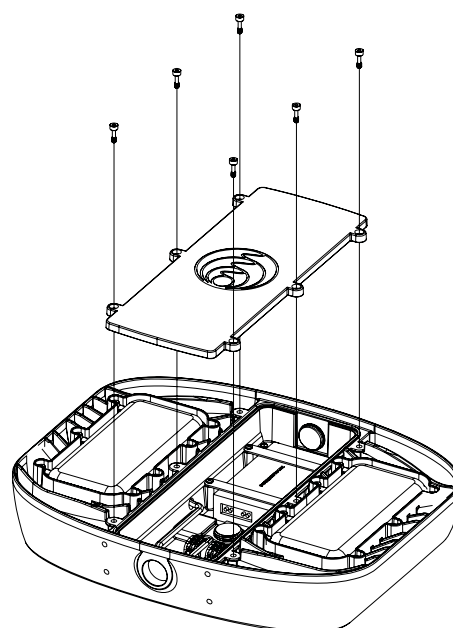

## Step 6.

Feed wire into Power Supply cavity.

Strip 100mm (4") of cable casing and strip conductors 8mm (0.32").

NOTE: If using cable, terminate the supply end in a suitable Listed metal junction box using a suitable Listed fitting approved for installation location as required.

All field wiring supply conductors shall be rated 90°C minimum and rated for supply voltage (300V AC Models, 600V HV models).

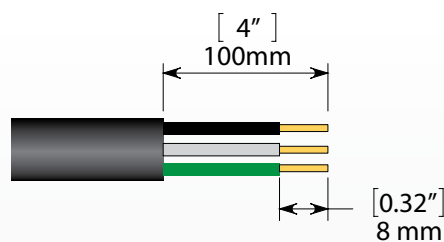

## Step 7.

Make wiring connections from branch circuit conductors to factory provided lead wires. Refer to NEC/CEC codes and follow all applicable local standards.

The MR luminaire is suitable for daisy-chain wiring of multiple luminaires on a single circuit. Input supply wiring through one NPT hub as described in Step 5 above. Feed input wiring into the luminaire and connect to LED driver supply wires using the wiring connectors provided. Connect output wiring using the same wiring connectors. Feed output wiring through the remaining NPT hub as described in Step 5 above.

For dimming, connect 18AWG or larger conductors to dimming connection points.

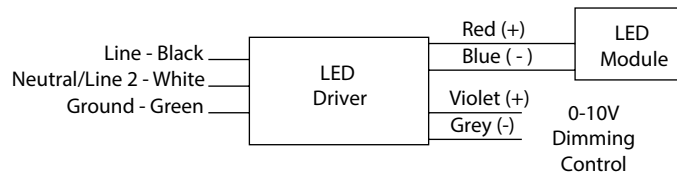

## Step 8.

Close Power Supply Cavity Lid.

A. Re-install the power supply lid using six (6) Captive M4 screws.

B. Tighten M4 Captive screws to 2 Nm (17in-lbs)

## Pole Mount Installation (Ordered Separately)

Refer to alternate instructions if using Wall, Yoke, Conduit or Hook Mount

This SPX-BKT-MR-PM kit is intended for use with UL Listed MR Bay luminaire as marked on the luminaire nameplate.

### Accessory Package Contents

SPX-BKT-MR-PM	QTY	PART NAME
	1	POLE MOUNT
	1	POLE MOUNT GASKET
	4	M6 X 25mm HEX HEAD CAP SCREW
	4	M6 FLAT WASHER
	1	M6 X 16mm HEX HEAD CAP SCREW
	1	3/4 NPT THREADED SMOOTH BORE BUSHING

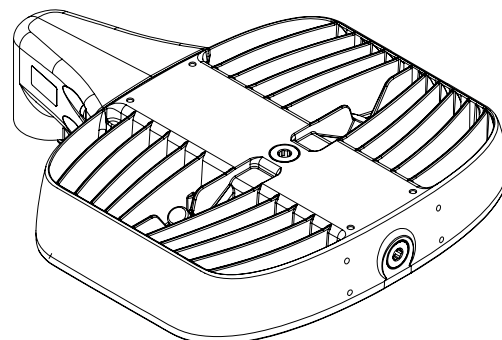

## Installation Instructions

### Step 1.

Inspect shipping package and contents to ensure no damage has occurred during shipping.

### Step 2.

Install the provided plastic 3/4" bushing.

### Step 3.

Install Pole Mount and gasket with adhesive side applied to mount and included M6 bolts and washers.

Torque to 7 N-m (62 in-lbs)

### Step 4.

Thread fixture assembly onto 1.5" NPT pole.

### Step 5.

Insert and tension M6 set screw to pole to lock rotation.

Torque to 5 N-m or 44 in-lbs.

### Step 6.

Resume installation instructions provided with fixture. (STEP 4)

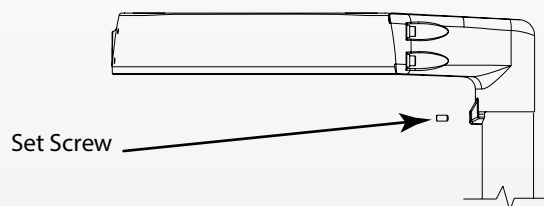
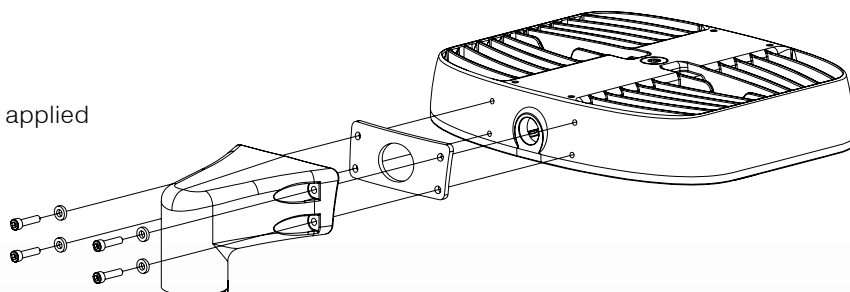
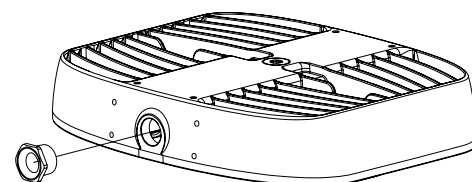

## Wall Mount Installation (Ordered Separately)

Refer to alternate instructions if using Pole, Yoke, Conduit or Hook Mount

This SPX-BKT-MR-WM kit is intended for use with UL Listed MR Bay luminaire as marked on the luminaire nameplate.

### Accessory Package Contents

SPX-BKT-MR-WM	QTY	PART NAME
	1	WALL MOUNT
	1	WALL MOUNT PLATE
	1	WALL MOUNT PLATE SIDE GASKET
	1	WALL MOUNT GASKET
	4	6 x 25mm SOCKET HEAD CAP SCREW
	4	M4x 10mm FLAT HEAD SOCKET CAP SCREW
	4	M6 FLAT WASHER
	3	3/4 NPT HEX CAP PLUG
	1	3/4 NPT THREADED SMOOTH BORE BUSHING

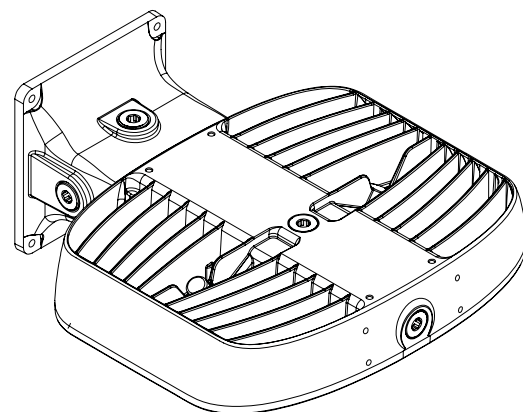

## Installation Steps

### Step 1.

Inspect shipping package and contents to ensure no damage has occurred during shipping.

### Step 2.

Install provided 3/4 NPT conduit plugs in desired locations. To maintain ingress rating all NPT entries not used for wiring connections are required to be plugged. Torque to 10 Nm (88 in-lbs)

NOTE: To aid in assembly and protection against ingress use of a petrolatum or soap thickened mineral oil based thread lubricant/sealant is necessary.

### Step 3.

Install provided 3/4" NPT plastic bushing.

### Step 4.

Install Wall Mount main body with included M6 bolts and washers and adhesive backed gasket. Apply gasket to mount with adhesive backed side. Torque to 7 N-m (62 in-lbs)

### Step 5.

Install Back Cover Plate with 4x M4 Flat head screws and adhesive backed gasket. Apply gasket with adhesive side applied to mount main body.

Torque to 2 N-m (17 in-lbs)

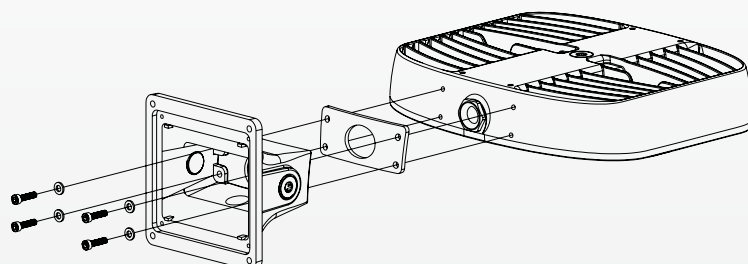
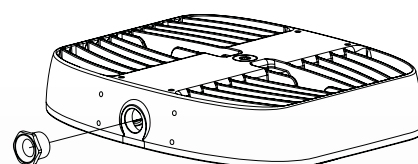
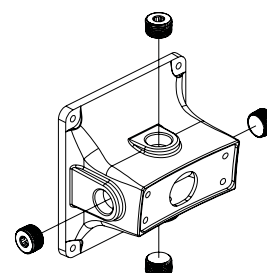

## Wall Mount Installation (Ordered Separately)

### Step 5.

Install Back Cover Plate with 4x M4 Flat head screws and adhesive backed gasket. Apply gasket with adhesive side applied to mount main body.

Torque to 2 N-m (17 in-lbs)

### Step 6.

Mount fixture assembly to desired location using 4x 1/4-20 OR M6 Screws or Bolts.

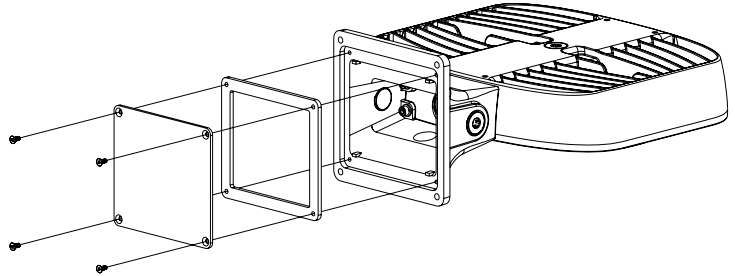

### Step 7.

Install appropriate Listed 3/4" NPT cable gland for cable size to desired entry location and be sure to follow all applicable local electrical codes for the specific hazardous locations. Torque cable gland base and dome nut to manufacturer's recommended specification. OR Install Direct Rigid Conduit as per local electrical code. For direct rigid conduit installation, torque hand tight plus 2 to 3 turns.

NOTE: To aid in assembly and protection against ingress use of a petrolatum or soap thickened mineral oil based thread lubricant/sealant is necessary.

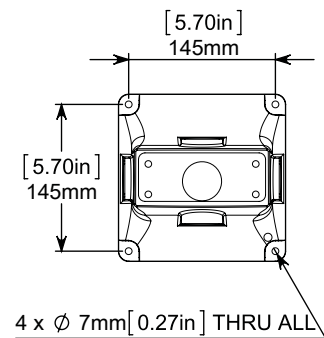

### Step 8.

Resume installation instructions provided with fixture.  
(STEP 4)

## Yoke Mount Installation (Ordered Separately)

Refer to alternate instructions if using Pole, Wall, Conduit or Hook Mount

This SPX-BKT-MR-YM kit is intended for use with UL Listed MR Bay luminaire as marked on the luminaire nameplate.

### Accessory Package Contents

SPX-BKT-MR-YM	QTY	PART NAME
	1	YOKE MOUNT A
	1	YOKE MOUNT B
	4	1/4-20 HEX NUT
	4	1/4" FLAT WASHER
	4	1/4-20 x 0.5in CARRIAGE BOLT

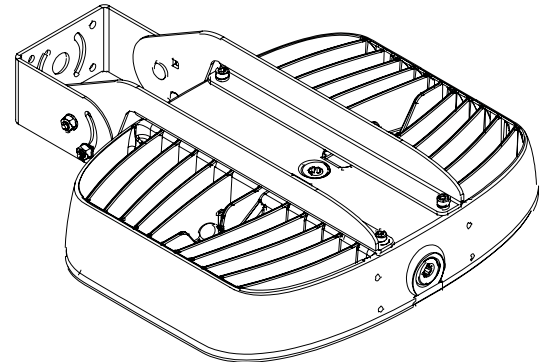

## Installation Steps

### Step 1.

Inspect shipping package and contents to ensure no damage has occurred during shipping.

### Step 2.

Assemble Yoke mount with carriage bolts on inside and with washers and nuts.

Note: By alternating the rotation mounting hole you can determine either an upward swing or downward swing.

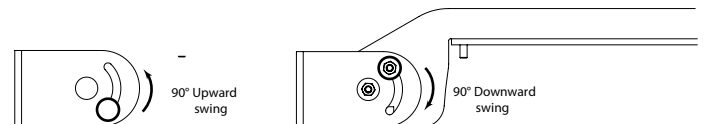

### Step 3.

Install Yoke Mount with included M6 bolts and washers to MR Head.

Torque to 7 N-m (62 in-lbs)

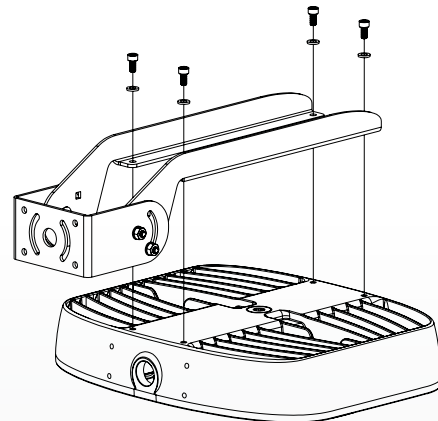

### Step 4.

Mount fixture assembly to desired location 2-4x 1/4-20 OR M6 Screws or Bolts.

### Step 5.

Adjust and Aim fixture to desired position. Torque hardware nuts to 9 N-m (80 in-lbs).

### Step 6.

Resume installation instructions provided with fixture. (STEP 4)

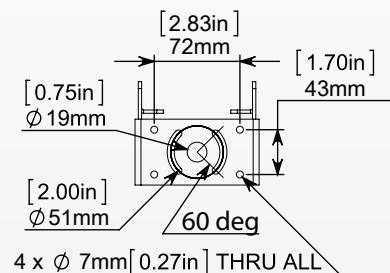



## High Vibration Yoke Installation (Ordered Separately)

Refer to alternate instructions if using Conduit, Hook, Pole, Wall Mount, or Yoke Mount

This SPX-BKT-MR-YK kit is intended for use with UL Listed MR Bay luminaire as marked on the luminaire nameplate.

### Accessory Package Contents

SPX-BKT-MR-YK	QTY	PART NAME
	1	MR HIGH VIBRATION YOKE
	2	CHEEK PLATE
	8	M6 x 1 x 25mm SOCKET FLAT HEAD CAP SCREW
	4	M6 FLAT WASHER
	4	M6 x 1 x 16mm SOCKET HEAD CAP SCREW

## Installation Steps

### Step 1.

Inspect shipping package and contents to ensure no damage has occurred during shipping. Discard surface/ ceiling mounting bracket provided with MR luminaire.

### Step 2.

Mount MR high vibration yoke to mounting surface using a minimum of 4x ¼-20 or M6 fasteners (not provided).

### Step 3.

Install suitable wiring system to the conduit opening per CEC/NEC requirements for the specific location of install.

NOTE: To aid in assembly and protection against ingress use of a petrolatum or soap thickened mineral oil based thread lubricant/sealant is necessary.

Un-used conduit opening must be plugged to maintain the integrity of the enclosure.

### Step 4.

Mount MR Cheek Plates to sides of MR luminaire using 4x M6 flat head cap screws per side. Thread one cheek plate over installed wiring during assembly. Torque fasteners to 5 Nm (45 in-lbs).

### Step 5.

Thread installed wiring through opening in MR high vibration yoke mount and install MR luminaire into yoke. The raised circular bosses on the MR cheek plates should register inside of the large circular holes on the MR high vibration yoke mount arms. Rotate luminaire to aim in the desired direction and fasten in place using 2x M6 socket head cap screws and flat washers per side. Torque fasteners to 5 Nm (45 in-lbs).

### Step 6.

Resume installation instructions provided with luminaire. (STEP 4 in MR Installation Instructions provided with Luminaire)

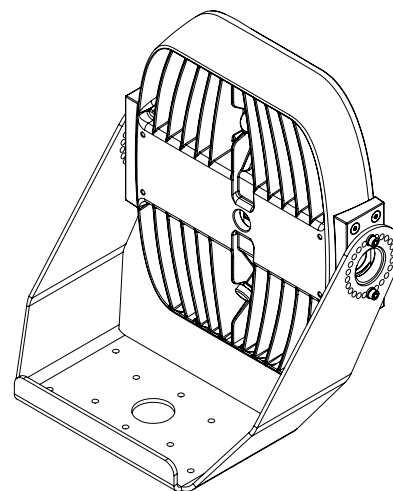

Step 2

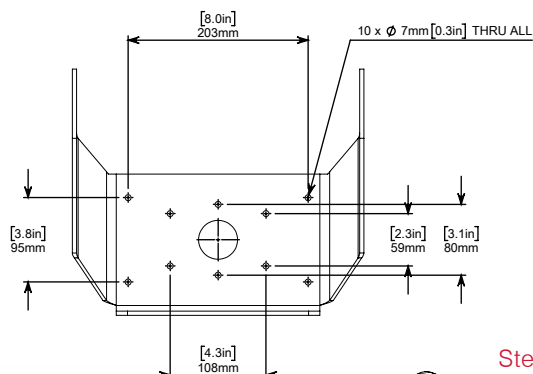

Step 4

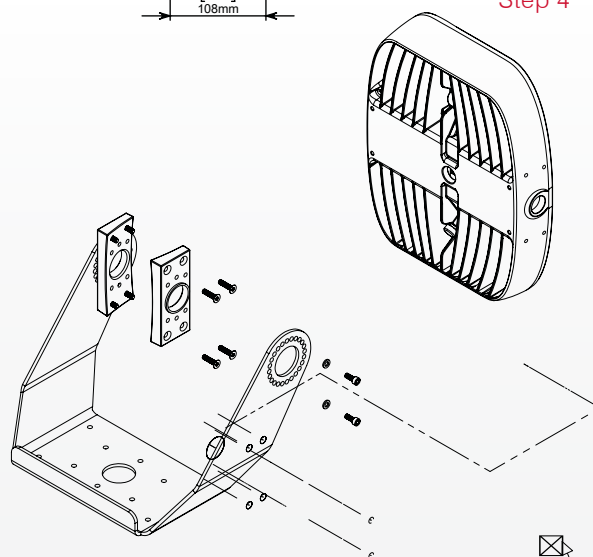

WARNING: The MR Head must not face upwards by any degree beyond the vertical position for Class II, Division 2, Zone 22, and Class III hazardous locations.

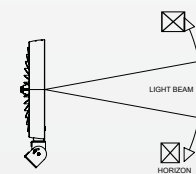

## Conduit Connection (Ordered Separately)

Refer to alternate instructions if using Pole, Wall, Yoke or Hook Mount

This SPX-BKT-MR-CC kit is intended for use with UL Listed MR Bay luminaire as marked on the luminaire nameplate.

### Accessory Package Contents

SPX-BKT-MR-CC	QTY	PART NAME
	1	ANTI-ROTATION BRACKET ASSEMBLY

## Installation Steps

### Step 1.

Inspect shipping package and contents to ensure no damage has occurred during shipping. Discard surface/ ceiling mounting bracket provided with MR luminaire.

### Step 2.

Slide anti-rotation lock onto suitably mounted hanging conduit and install luminaire onto 3/4" conduit. Slide anti-rotation lock into place and tighten set screw to lock unit in place. Tighten the anti-rotation lock set screw to 5 N-m (44 in-lbs). Fixed Rigid Metal Conduit must be suitably mounted to prevent rotation.

NOTE: To aid in assembly and protection against ingress use of a petrolatum or soap thickened mineral oil based thread lubricant/sealant is necessary.

Un-used conduit opening must be plugged to maintain the integrity of the enclosure.

### Step 3.

Install Secondary Safety Cable by looping appropriate steel cable or chain through the outer band of the unit and fastening a closed loop. Secondary safety hardware must be rated for a minimum of 50lbs.

Install remaining loop of secondary safety chain or steel cable to suitable mounting location and fasten securely. Secondary safety hardware must be rated for 50lbs.

### Step 4.

Resume installation instructions provided with Fixture. (STEP 4)

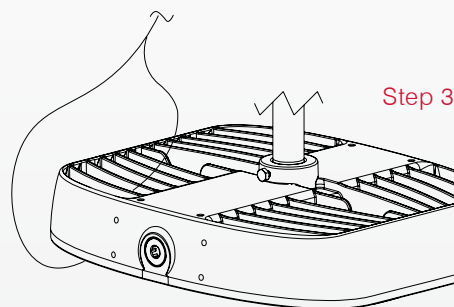
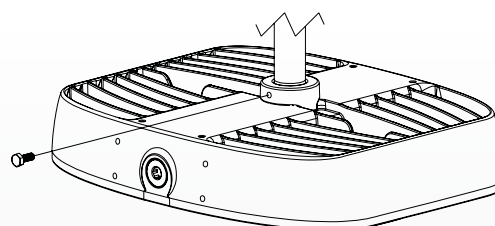
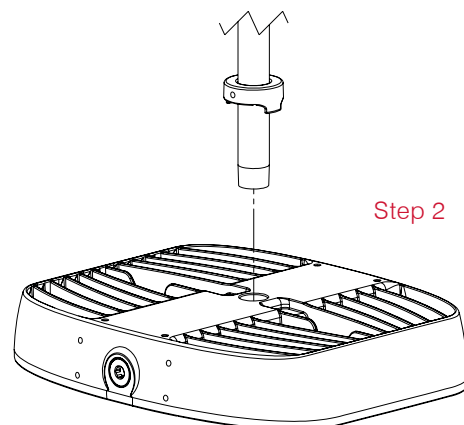
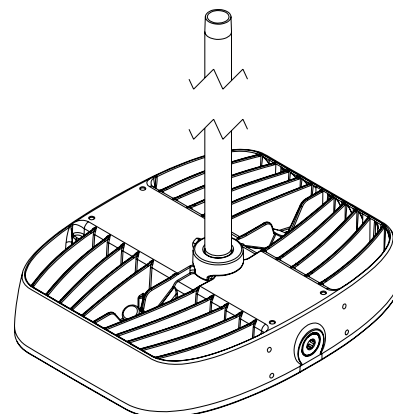

## Hook Pendant Installation (Ordered Separately)

Refer to alternate instructions if using Pole, Wall, Yoke or Conduit Mount

This SPX-BKT-MR-HK kit is intended for use with UL Listed MR Bay luminaire as marked on the luminaire nameplate.

### Accessory Package Contents

SPX-BKT-MR-HK	QTY	PART NAME
	1	PENDANT HOOK ASSEMBLY
	1	ANTI-ROTATION ASSEMBLY

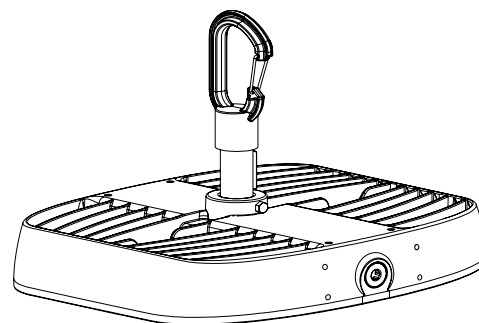

## Installation Steps

### Step 1.

Inspect shipping package and contents to ensure no damage has occurred during shipping. Discard surface/ceiling mounting bracket provided with MR luminaire.

### Step 2.

It is recommended to install Secondary Safety Cable by looping appropriate steel cable or chain through the outer band of the unit and fastening a closed loop. Secondary safety hardware must be rated for a minimum of 50lbs. Secondary safety cables made from stainless steel aircraft cable are available upon request.

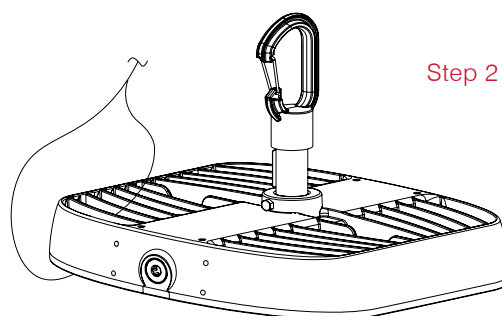

Step 2

### Step 3.

Slide anti-rotation lock onto suspension hook assembly and install hook assembly into 3/4 NPT threaded entry. Tighten to hand tight plus 1 to 2 turns. Slide anti-rotation lock into place and tighten set screw to lock unit in place.

NOTE: To aid in assembly and protection against ingress use of a petrolatum or soap thickened mineral oil based thread lubricant/sealant is necessary.

Un-used conduit opening must be plugged to maintain the integrity of the enclosure.

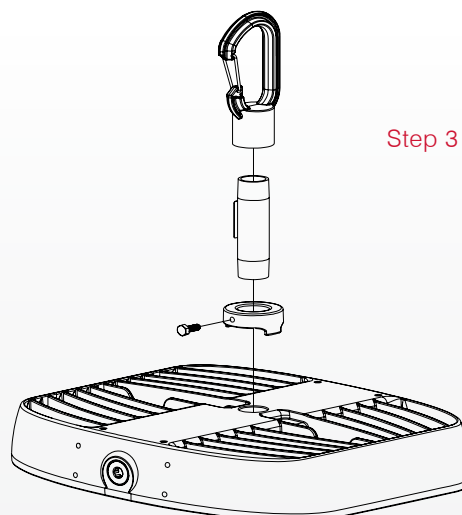

Step 3

### Step 4.

Latch hook onto eye-bolt or other fixed mounting loop. Mounting point must be rated for a minimum of 50lbs.

### Step 5.

Install remaining loop of secondary safety chain or steel cable to suitable mounting location and fasten securely.

### Step 6.

Resume installation instructions provided with Fixture. (STEP 4)

## Slip Fitter Yoke Mount (Ordered Separately)

This SPX-BKT-MR-SFY kit is intended for use with UL Listed MR Bay luminaire as marked on the luminaire nameplate.



### Warning

Listing for Class II, Division 2, Zone 22, Class III and Nonrecessed Marine Luminaire and the IP66 or IP66/67 rating are Limited to using the mount for mechanical support only and not part of the wiring system.

#### Accessory Package Contents

SPX-BKT-MR-SFY	QTY	PART NAME
	2	M6 X 16mm FLAT HEX HEAD SOCKET CAP SCREW
	1	SEALED CAP
	2	M8 X 25mm SOCKET HEAD CAP SCREWS
	6	3/8" HEX BOLTS
	4	M6 X 16mm HEX HEAD CAP SCREW
	1	SLIP FITTER YOKE MOUNT (2x PIECES)

## Installation Steps

### Step 1.

Inspect shipping package and contents to ensure no damage has occurred during shipping.

### Step 2.

Remove both M6 flat head cap screws using a 4mm hex key and remove sealed cap. If required angle is known, adjust fixture angle by loosening two M8 socket head cap screws inside the slip fitter yoke using a 6mm hex key Torque to 17N-m (13ft-lb).

NOTE: Aiming angle can be adjusted after Step 6.

**WARNING:** When installing the slip fitter pole mount onto the model AR luminaires the lens of the luminaire must not face upwards any degree beyond the vertical position for Class II, Division 2, Zone 22 and Class III hazardous location installations. Refer to figure.

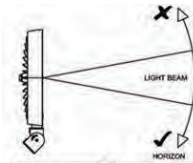

### Step 3.

**Warning:** When installing the slip fitter pole mount onto the model AR luminaires the lens of the luminaire must not face upwards any degree beyond the vertical position for Class II, Division 2, Zone 22 and Class III hazardous location installations. Refer to figure.

NOTE: aiming can be adjusted up to 180° in either direction after installation by loosening the 6 pinch bolts adjusting rotation and tightening again. DO NOT TURN BEYOND 180° as this will induce twist and strain on conductors after wiring.

### Step 4.

**Warning:** Listing for Class II, Division 2, Zone 22, Class III and Nonrecessed Marine Luminaire and the IP66 or IP66/67 rating are Limited to using the mount for mechanical support only (¾" NPT Conduit entry covered by mount is to be plugged using provided plugs) and not part of the wiring system.

Install a suitable wiring system that complies with the wiring methods permitted in the Canadian Electrical Code or the National Electrical Code for the classification of the hazardous locations area of installation.

### Step 5.

Ensure wiring system has appropriate strain relief in the luminaire by tying a large enough knot using the supply field wiring in the wiring compartment such that it cannot be pulled through the ¾" inch NPT entry of the luminaire.

### Step 6.

Secure slip fitter yoke to fixture with four M6 hex head cap screws using a 10mm socket. Torque to 7N-m (62in-lbs)

### Step 7.

Close sealed cap on slip fitter pole mount. Torque to 7N-m (62in-lbs)

### Step 8.

Follow the wiring instructions specified in the main installation instructions provided with the AR luminaire as applicable for making connections with the luminaire lead wires and testing the system.

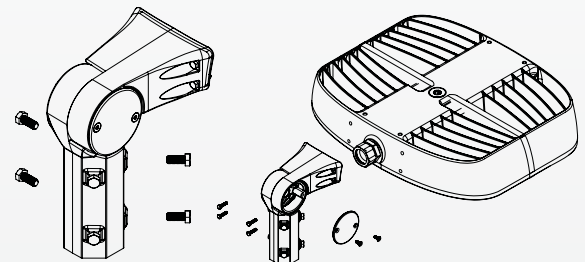
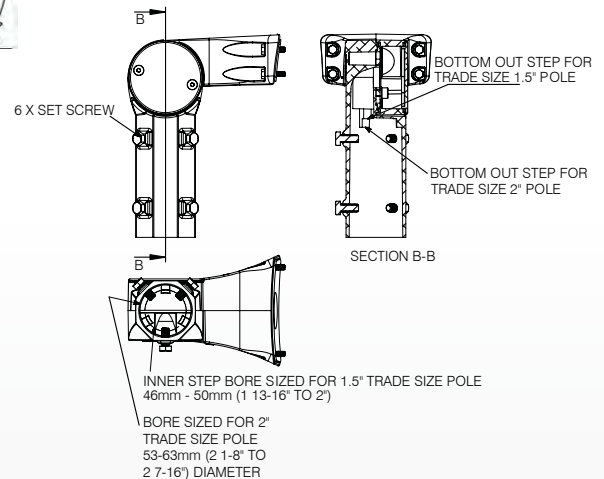
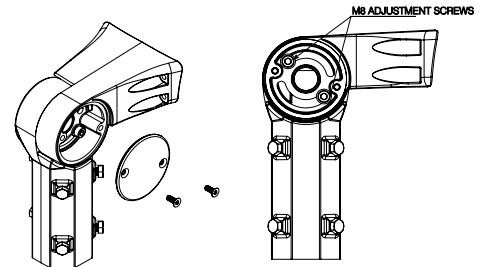
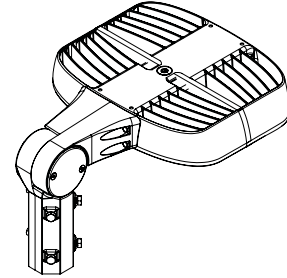

## Secondary Safety Kit (Ordered Separately)

This SPX-BKT-MR-SK-## kit is intended for use with UL Listed MR Bay luminaire as marked on the luminaire nameplate.

### Accessory Package Contents

SPX-BKT-MR-SK-##	QTY	PART NAME
	1	Secondary Safety Bracket
	1	M6 Flat Washer
	1	M6 x 20mm Hex Cap Screw
	2	Oval Shaped Threaded Connecting Link
	1	Stainless Steel Chain, 1/8" Trade Size

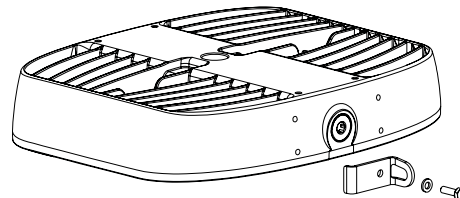

## Installation Steps

### Step 1.

Remove the bottom-left pre-installed M6 x 16mm Hex Cap Screw.

### Step 2.

Install bracket on MR luminaire as shown using supplied M6 x 20mm Hex Cap Screw. Torque M6 x 20mm Hex Cap Screw to 40 in-lbs (4.5 Nm). It is strongly recommended that a medium or high strength thread-locker be used when installing the bracket. For units using surface or suspension mounting, install safety kit hardware on top of the surface mount or suspension mount brackets in the same location as shown.

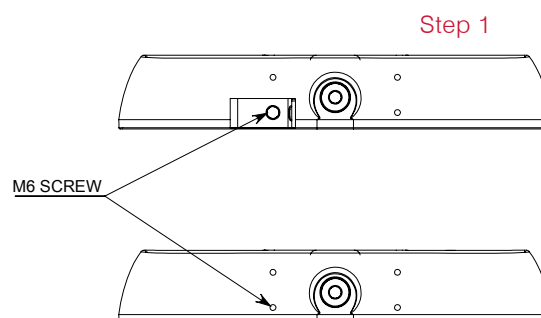

### Step 3.

Attach stainless steel chain to safety kit bracket using stainless steel oval shaped threaded connecting link.

### Step 4.

Attach loose end of chain. Secondary safety mounting point must be suitable for supporting a minimum of 50lbs:

- Attach loose end of stainless steel chain to fixed eye-bolt (not supplied) using the second stainless steel oval shaped threaded connecting link.
- Alternate attachment method: Wrap loose end of chain around fixed beam or other immovable support and create a closed loop using the second stainless steel oval shaped threaded connecting link. Supporting beam or structure must form a closed loop to prevent the secondary safety chain from slipping off or becoming unhooked.

